

DK. Reservedele  
 UK. Spare Parts  
 DE. Ersatzteile

ASTM F 963  
 ANSI Z315.1  
 16 CRF 1303

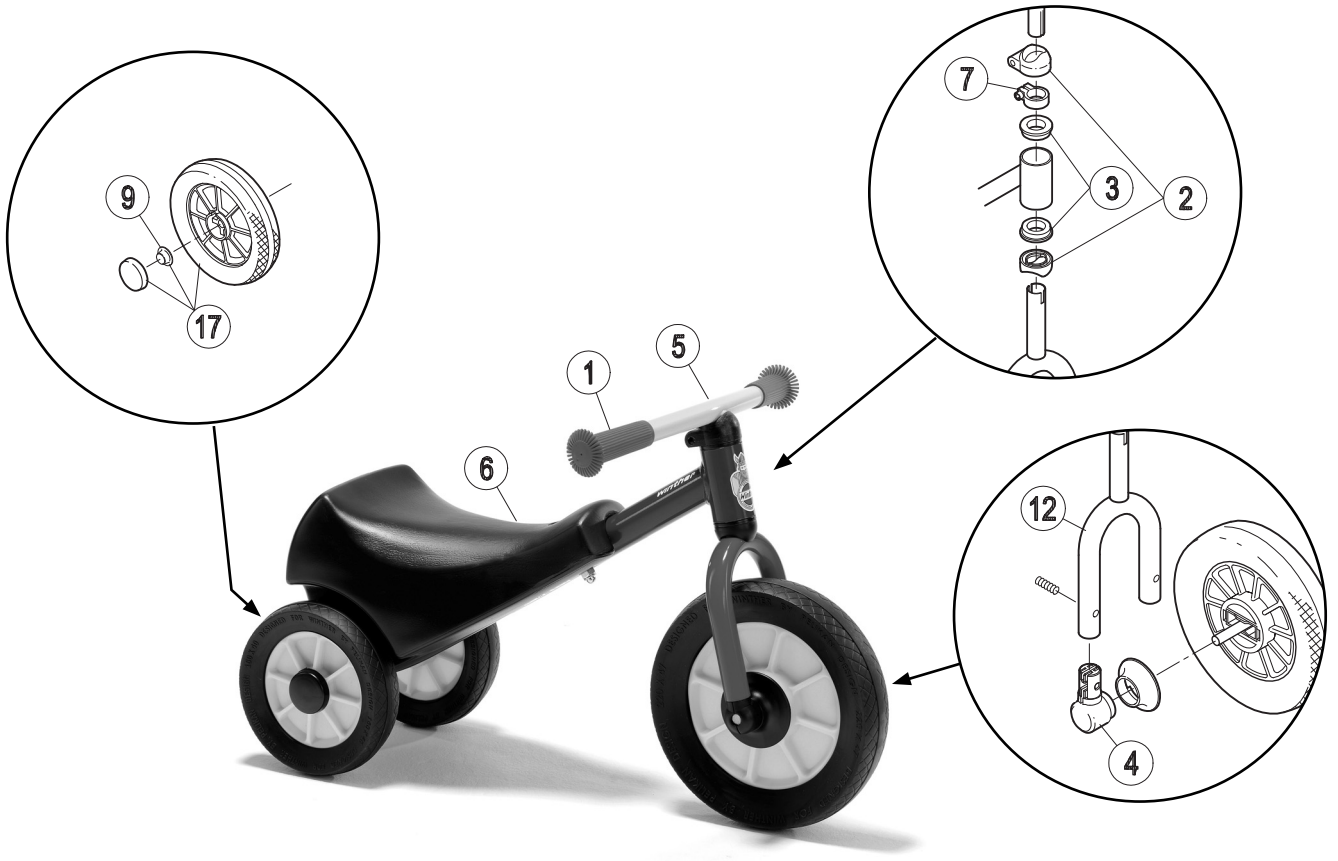

Pos.		Pos.		Pos.	
1	x2	7	x1  x1	13	
2	x1  x1	8		14	
3	x2	9	x4	15	
4	x2  x2  x1	10		16	
5		11		17	
6		12		18	

DK. Reservedele  
 UK. Spare Parts  
 DE. Ersatzteile

ASTM F 963  
 ANSI Z315.1  
 16 CRF 1303

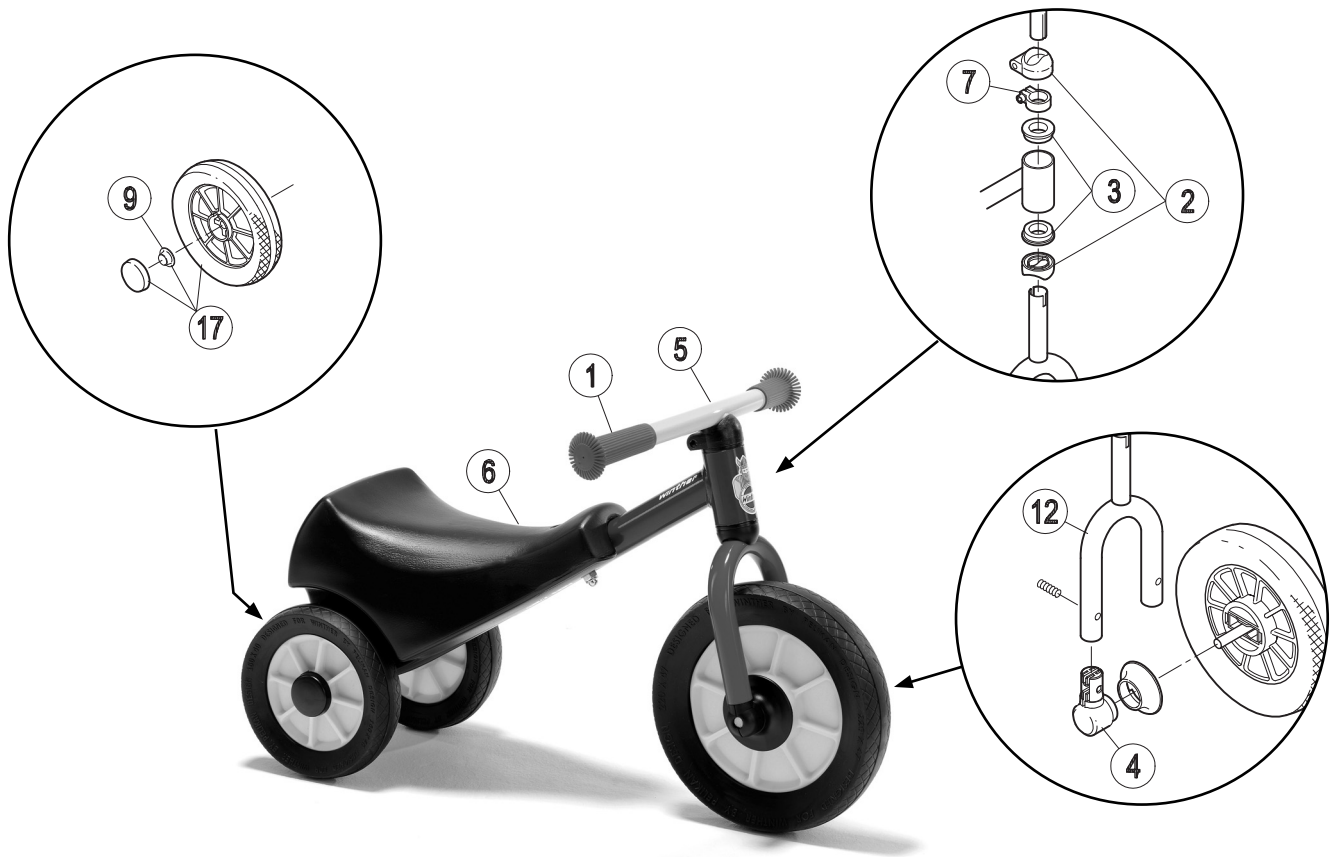

	43814		43820		
	Version		Version		
Pos.	1.2	2.0	1.2	2.0	
1	50015	50015	50001	50001	
2	50002	50068	50002	50068	
3	50003	50003	50003	50003	
4	50004	50004	50004	50004	
5	50138	50139	50140	50066	
6	50041	50041	50041	50041	
7	50105	50067	50105	50067	
8	-	-	-	-	
9	50008	50008	50008	50008	
10					
11	50036	50069	50027	50064	
12	-	50107	-	50107	
13	-	-	-	-	
14	-	-	-	-	
15	-	-	-	-	
16	-	-	-	-	
17	50032	50073	50022	50078	
18	-	-	-	-	